

SCALE - 1:100

SCALE - 1:200

- Notes:
- Contact Ian Lang SLC Roads and Transportation Services 01698 453693.
 - Awarded contractor will be required to submit a programme of works for approval.
 - All road markings to conform with Traffic Signs, Regulations and General Directions 2016 (TSRGD).
 - Provide 2300mm clearance from bottom of all signs to ground level unless otherwise detailed.
 - Replace existing Gully grating and frames with D400 loading to BS EN124 Pedestrian and Cycle friendly cross mesh style or similar type approved.
 - Awarded contractor to liaise direct with Lochwynd who will be responsible for works associated with Traffic Signal Installations to co-ordinate and programme works associated with physical islands/NAL retention sockets and electrical connections.
 - All preformed cycle symbols to be medium size Diag no 1057 (1780 x 1100mm) unless otherwise detailed.
 - Aggregate Industries Eco Cycle Segregation have a lead in time for delivery. Awarded contractor to procure as soon as possible upon appointment.
 - For Glasdon cyclenmaster bollards refer to drawing number TE-SFPH1-004 (Types A - F).
 - Glasdon Cyclenmaster bollards to be bolt down base type where specified on segregation features.
 - New Cycleway to consist of 150mm Type 1, 50mm AC20 Binder Course and 30mm dense wearing course using 'Cloburn Quarry Stone with Macpac limestone filler.

KEY

	KERB REMOVAL
	FOOTWAY/CARRIAGEWAY EXCAVATION
	VERGE EXCAVATION
	ROAD MARKINGS REMOVAL
	SIGN REMOVAL
	LIGHTING COLUMN REMOVAL
	LIGHTING COLUMN (NEW)
	LIGHTING COLUMN TRACK/DUCT/CABLE
	GULLY REMOVAL
	BT CHAMBER (TO BE RESET)
	STREET LIGHTING CHAMBER (TO BE RESET)
	TREE (TO BE REMOVED)
	CARRIAGEWAY REGULATING
	RAMPED TRANSITION FOOTWAY LEVEL

Rev:	Date:	Revisions	Checked Date:	App'd Date:
South Lanarkshire Council, Community and Enterprise Resources				
Scale	: AS DETAILED	Date	: DEC 2020	
Drawn by	: ICL	Checked by	: ICL	
Drawing Status	: FINAL	Approved by	:	
Head of Roads and Transportation: Gordon Mackay B.Sc., C.Eng., M.I.C.E.				
154 Montrose Crescent, Hamilton, ML3 6LB				
SPACES FOR EVERYONE 2020-21 EAST KILBRIDE - PHASE 2 WEST MAINS ROAD CORRIDOR SHEET 2 OF 4				
Drawing No:	TE-SFE-PH1-2-002			
Rev:				
File No:	SFE PHASE - 1.2			
Original Drawing Size:				841*1189 (A0)

SCALE - 1:100

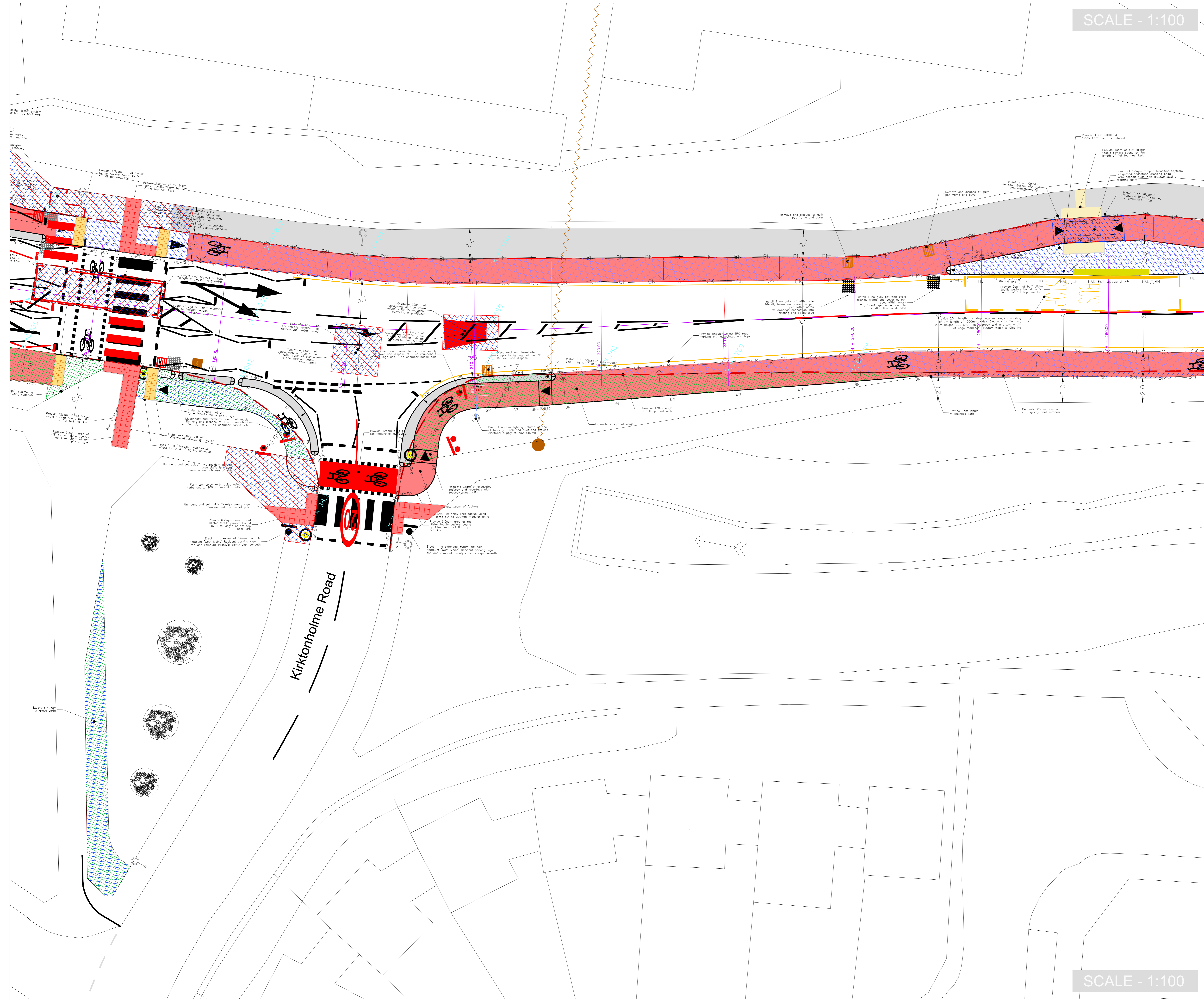

- Notes:
- Contact Ian Lang SLC Roads and Transportation Services 01698 453693.
 - Awarded contractor will be required to submit a programme of works for approval.
 - All road markings to conform with Traffic Signs, Regulations and General Directions 2016 (TSRGD).
 - Provide 2300mm clearance from bottom of all signs to ground level unless otherwise detailed.
 - Replace existing Gully grating and frames with D400 loading to BS EN124 Pedestrian and Cycle friendly cross mesh style or similar type approved.
 - Awarded contractor to liaise direct with Lochwynd who will be responsible for works associated with Traffic Signal Installations to co-ordinate and programme works associated with physical islands/NAL retention sockets and electrical connections.
 - All preformed cycle symbols to be medium size Diag no 1057 (1780 x 1100mm) unless otherwise detailed.
 - Aggregate Industries Eco Cycle Segregation kerbing have a lead in time for delivery. Awarded contractor to procure as soon as possible upon appointment.
 - For Glasdon cyclemaster bollards refer to drawing number TE-SFPPH1-004 (Types A - F).
 - Glasdon Cyclemaster bollards to be bolt down base type where specified on segregation features.
 - New Cycleway to to consist of 150mm Type 1, 50mm AC20 Binder Course and 30mm dense wearing course using 'Claburn Quarry Stone with Macpav limestone filler.

KEY

- KERBS REMOVAL
- FOOTWAY/CARRAGEWAY EXCAVATION
- VERGE EXCAVATION
- ROAD MARKINGS REMOVAL
- SIGN REMOVAL
- LIGHTING COLUMN REMOVAL
- LIGHTING COLUMN (NEW)
- LIGHTING COLUMN TRACK/DUCT/CABLE
- GULLY REMOVAL
- BT CHAMBER (TO BE RESET)
- STREET LIGHTING CHAMBER (TO BE RESET)
- TREE (TO BE REMOVED)
- CARRAGEWAY REGULATING
- RAMPED TRANSITION FOOTWAY LEVEL

Rev:	Date:	Revisions	Checked Date:	Apprd Date:

**South Lanarkshire Council,
Community and Enterprise Resources**

Scale : AS DETAILED Date : DEC 2020

Drawn by : ICL Checked by : ICL

Drawing Status : FINAL Approved by :

Head of Roads and Transportation:
Gordon Mackay B.Sc., C.Eng., M.I.C.E.

154 Montrose Crescent, Hamilton, ML3 6LB

**SPACES FOR EVERYONE 2020-21
EAST KILBRIDE - PHASE 1.2
WEST MAINS ROAD CORRIDOR
SHEET 3 OF 4**

Drawing No: **TE-SFE-PH1-2-003**

File No: **SFE - PH1.2**

Original Drawing Size: 841x1189 (A0)

SCALE - 1:100

SCALE - 1:200

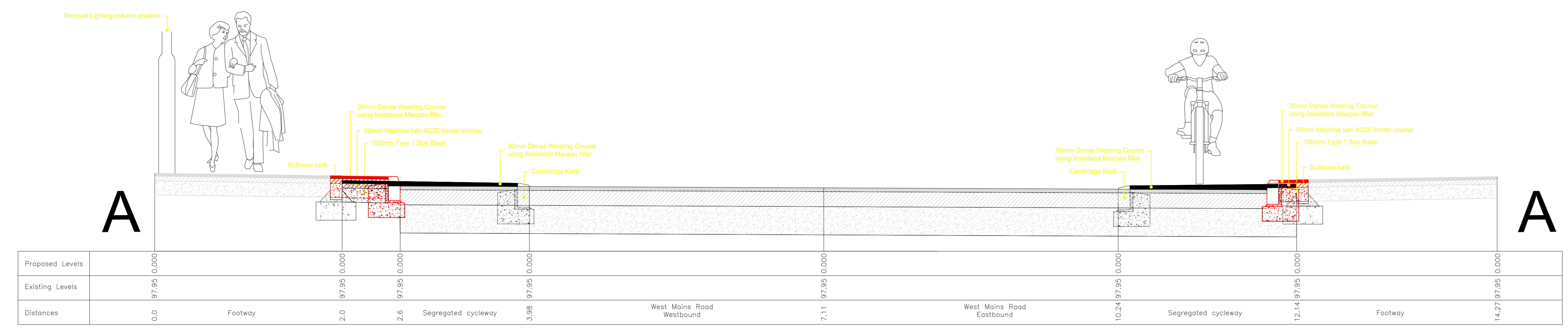

Proposed Levels	0.0	2.0	2.6	3.88	7.11	10.24	12.14	14.27
Existing Levels	97.95	97.95	97.95	97.95	97.95	97.95	97.95	97.95
Distances	0.0	2.0	2.6	3.88	7.11	10.24	12.14	14.27
	Footway	Segregated cycleway	West Mains Road Westbound	West Mains Road Eastbound	Segregated cycleway	Footway		

SECTION A-A

- Notes:
- Contact Ian Long SLC Roads and Transportation Services 01698 453693.
 - Awarded contractor will be required to submit a programme of works for approval.
 - All road markings to conform with Traffic Signs, Regulations and General Directions 2016 (TSRGD).
 - Provide 2300mm clearance from bottom of all signs to ground level unless otherwise detailed.
 - Replace existing Gully grating and frames with D400 loading to BS EN124 Pedestrian and Cycle friendly cross mesh style or similar type approved.
 - Awarded contractor to liaise direct with Lochwynd who will be responsible for works associated with Traffic Signal Installations to co-ordinate and programme works associated with physical islands/NAL retention sockets and electrical connections.
 - All preformed cycle symbols to be medium size Diag no 1057 (1780 x 1100mm) unless otherwise detailed.
 - Aggregate Industries Eco Cycle Segregation kerbing have a lead in time for delivery. Awarded contractor to procure as soon as possible upon appointment.
 - For Glasdon cyclemaster bollards refer to drawing number TE-SFPPH1-004 (Types A - F).
 - Glasdon Cyclemaster bollards to be bolt down base type where specified on segregation features.
 - New Cycleway to consist of 150mm Type 1, 50mm AC20 Binder Course and 30mm dense wearing course using 'Cloburn Quarry Stone with Macpav limestone filler.

KEY

- KERB REMOVAL
- FOOTWAY/CARRIAGEWAY EXCAVATION
- VERGE EXCAVATION
- ROAD MARKINGS REMOVAL
- SIGN REMOVAL
- LIGHTING COLUMN REMOVAL
- LIGHTING COLUMN (NEW)
- LIGHTING COLUMN TRACK/DUCT/CABLE
- GULLY REMOVAL
- BT CHAMBER (TO BE RESET)
- STREET LIGHTING CHAMBER (TO BE RESET)
- TREE (TO BE REMOVED)
- CARRIAGEWAY REGULATING
- RAMPED TRANSITION FOOTWAY LEVEL

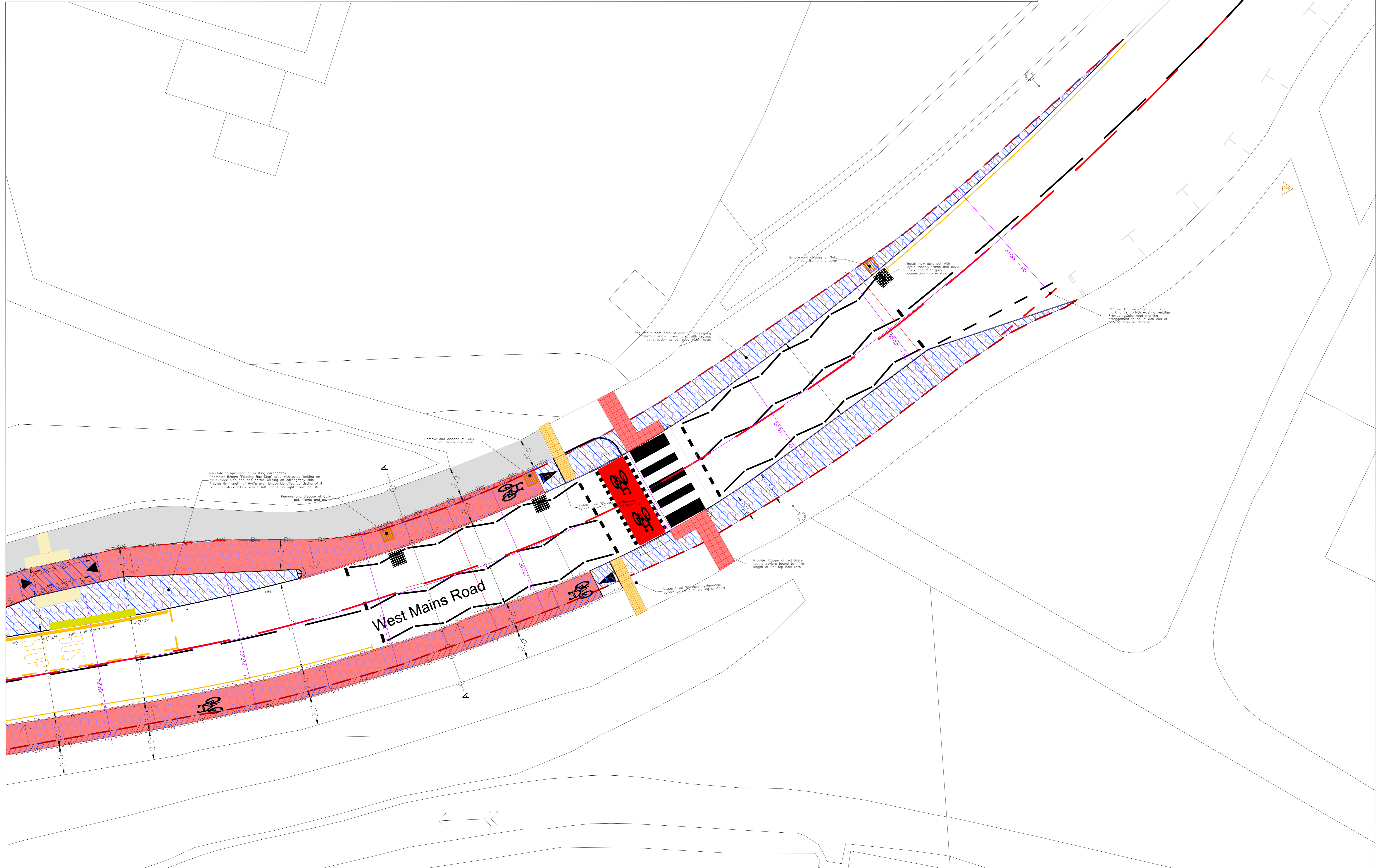

Rev:	Date:	Revisions	Checked Date:	App'd Date:
South Lanarkshire Council, Community and Enterprise Resources				
Scale	: AS DETAILED	Date	: DEC 2020	
Drawn by	: ICL	Checked by	: ICL	
Drawing Status	: FINAL	Approved by	:	
Head of Roads and Transportation: Gordon Mackay B.Sc., C.Eng., M.I.C.E.				
154 Montrose Crescent, Hamilton, ML3 6LB				
SPACES FOR EVERYONE 2020-21 EAST KILBRIDE - PHASE 1.2 WEST MAINS ROAD CORRIDOR SHEET 4 OF 4				
Drawing No:	TE-SFE-PH1-2-004			
Rev:				
File No:	SFE-PH1.2			

