

ROAD SIGNS AND MARKINGS (1.0)  
SCALE N.T.S.

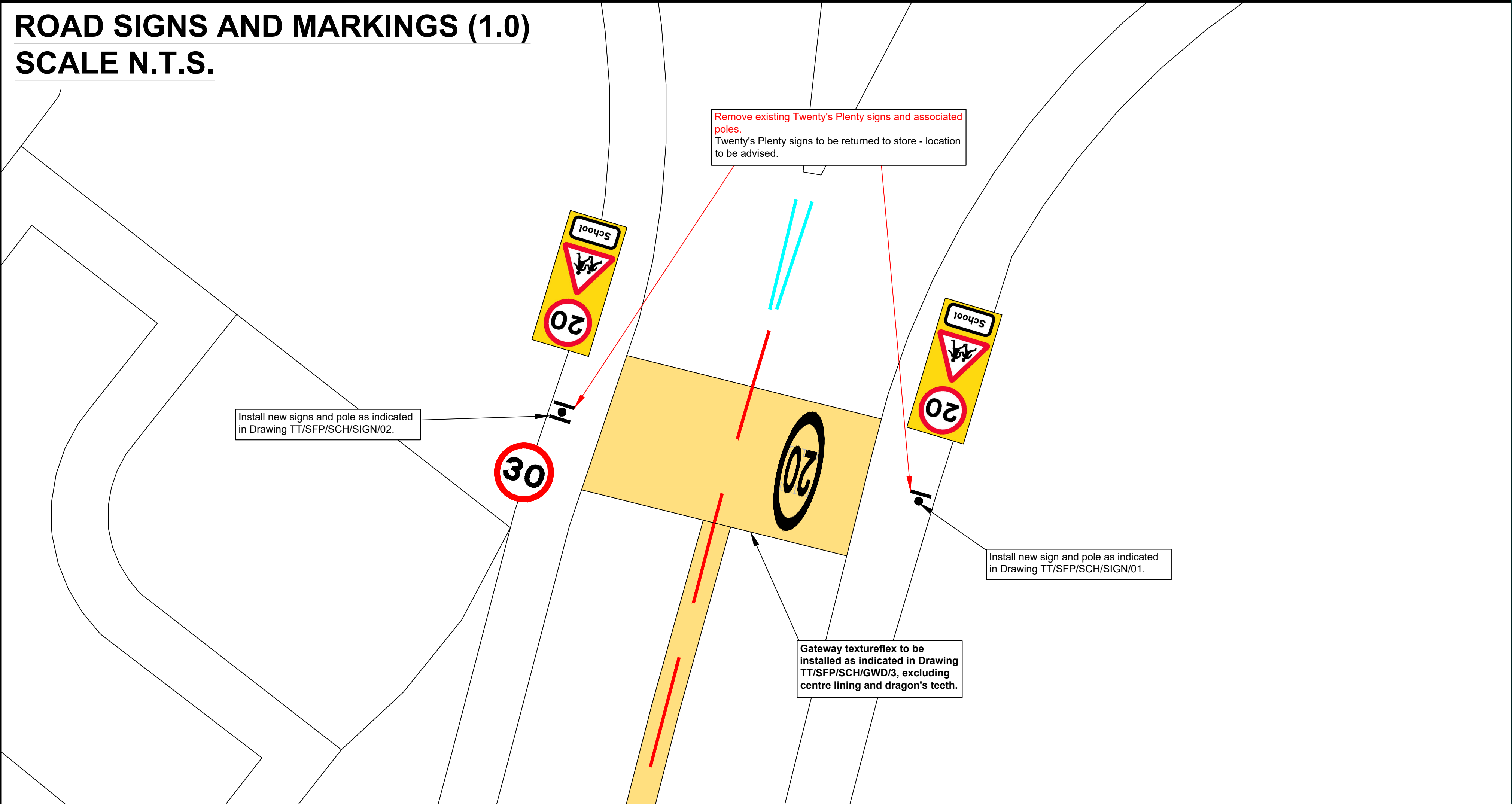

LOCATION PLAN  
SCALE N.T.S.

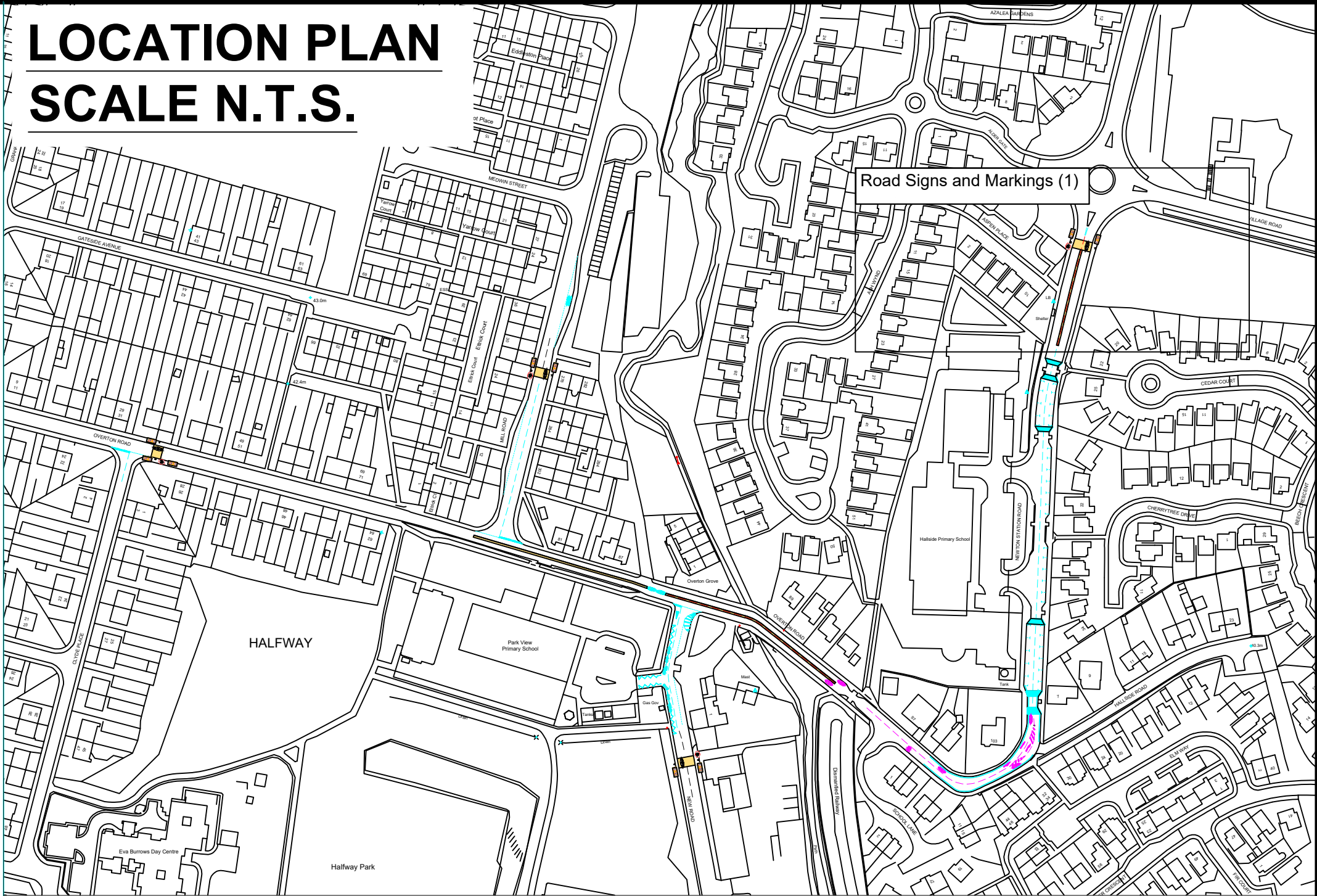

KEY

- New road markings to be laid in white thermoplastic
- New yellow textureflex surfacing to be laid
- Existing road markings to be removed
- Existing road markings to be refreshed
- Existing road markings to be retained
- New sign to be erected on new pole (existing signs and poles to be removed as indicated)
- New signs to be erected back-to-back on new pole (existing signs and poles to be removed as indicated)
- Existing sign and pole to be removed

ROAD SIGNS AND MARKINGS (1.1)  
SCALE N.T.S.

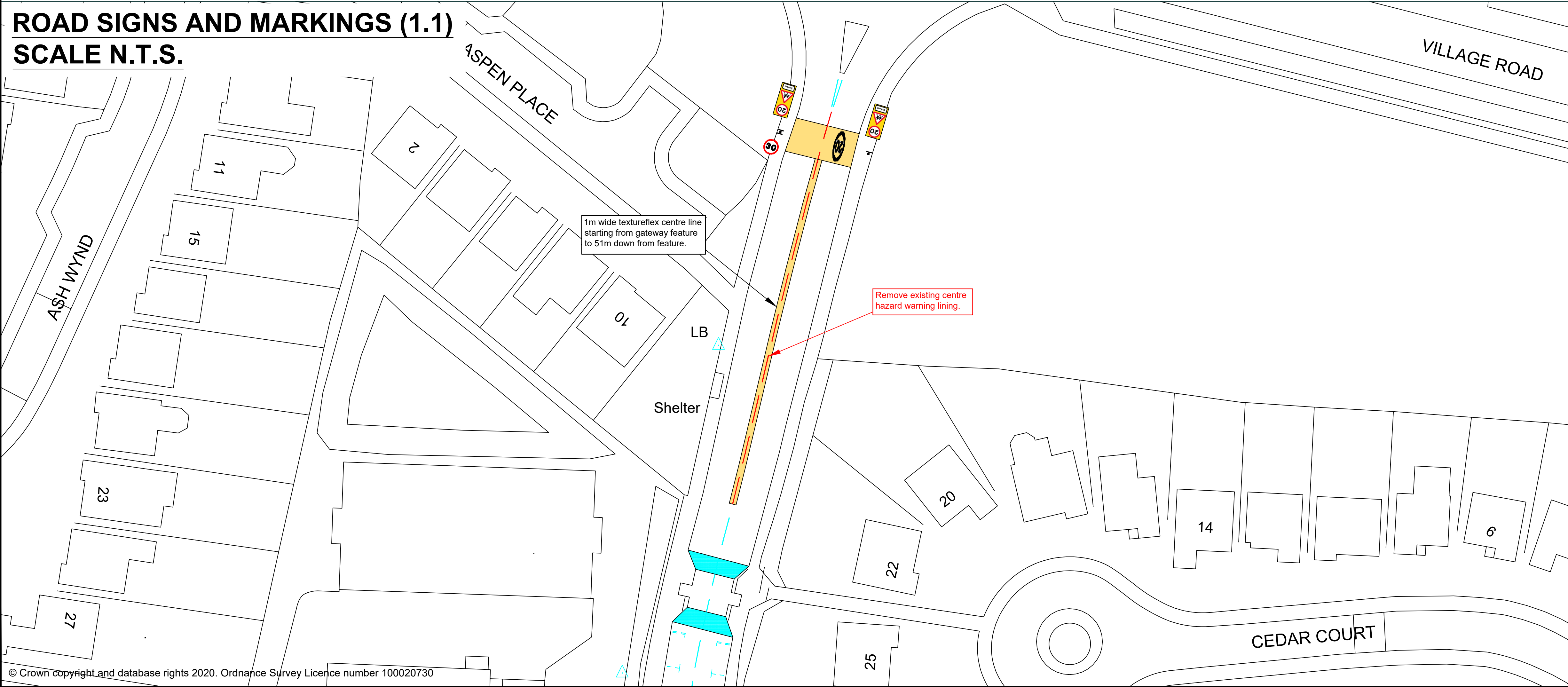

Notes

1. Refer to Standard Drawings for dimensions.

2. Contact Chris Murphy of SLC Traffic & Transportation on 07385 370094 if in doubt.

3. All road signs and markings to conform to TSRGD 2016.



ROAD SIGNS AND MARKINGS (2.0)  
SCALE N.T.S.

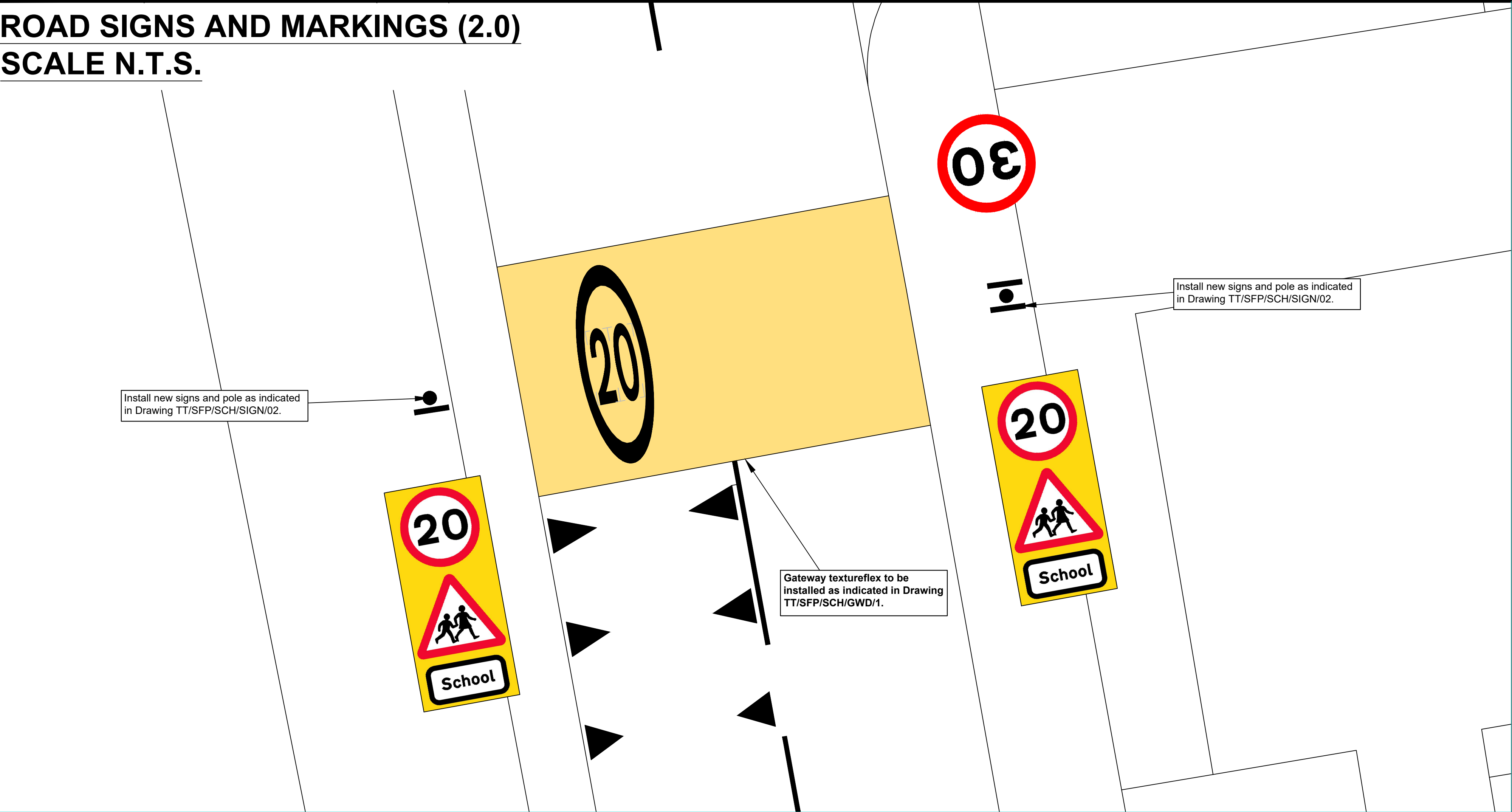

LOCATION PLAN  
SCALE N.T.S.

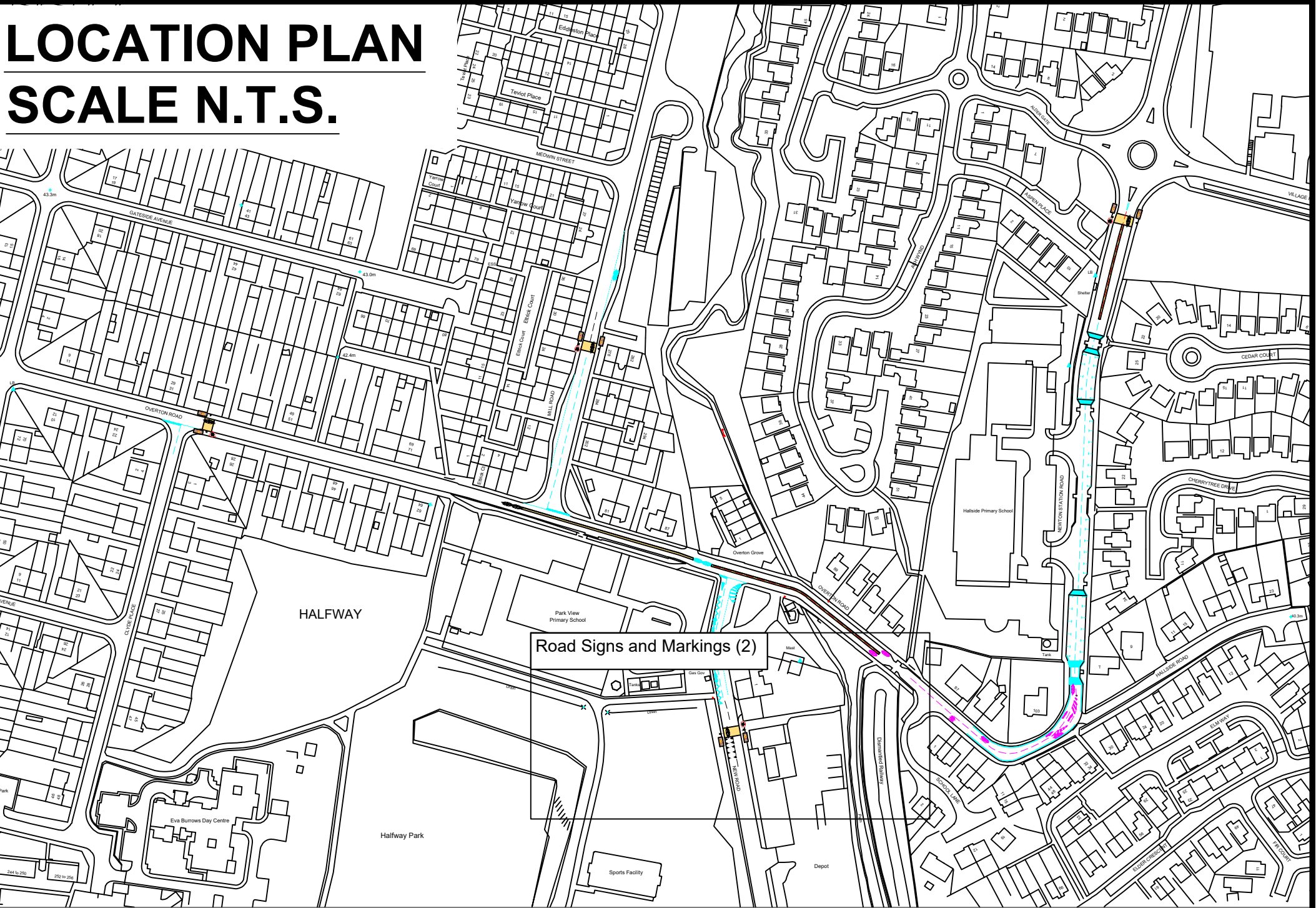

KEY

- New road markings to be laid in white thermoplastic
- New yellow textureflex surfacing to be laid
- Existing road markings to be removed
- Existing road markings to be refreshed
- Existing road markings to be retained
- New sign to be erected on new pole (existing signs and poles to be removed as indicated)
- New signs to be erected back-to-back on new pole (existing signs and poles to be removed as indicated)
- Existing sign and pole to be removed

ROAD SIGNS AND MARKINGS (2.1)  
SCALE N.T.S.

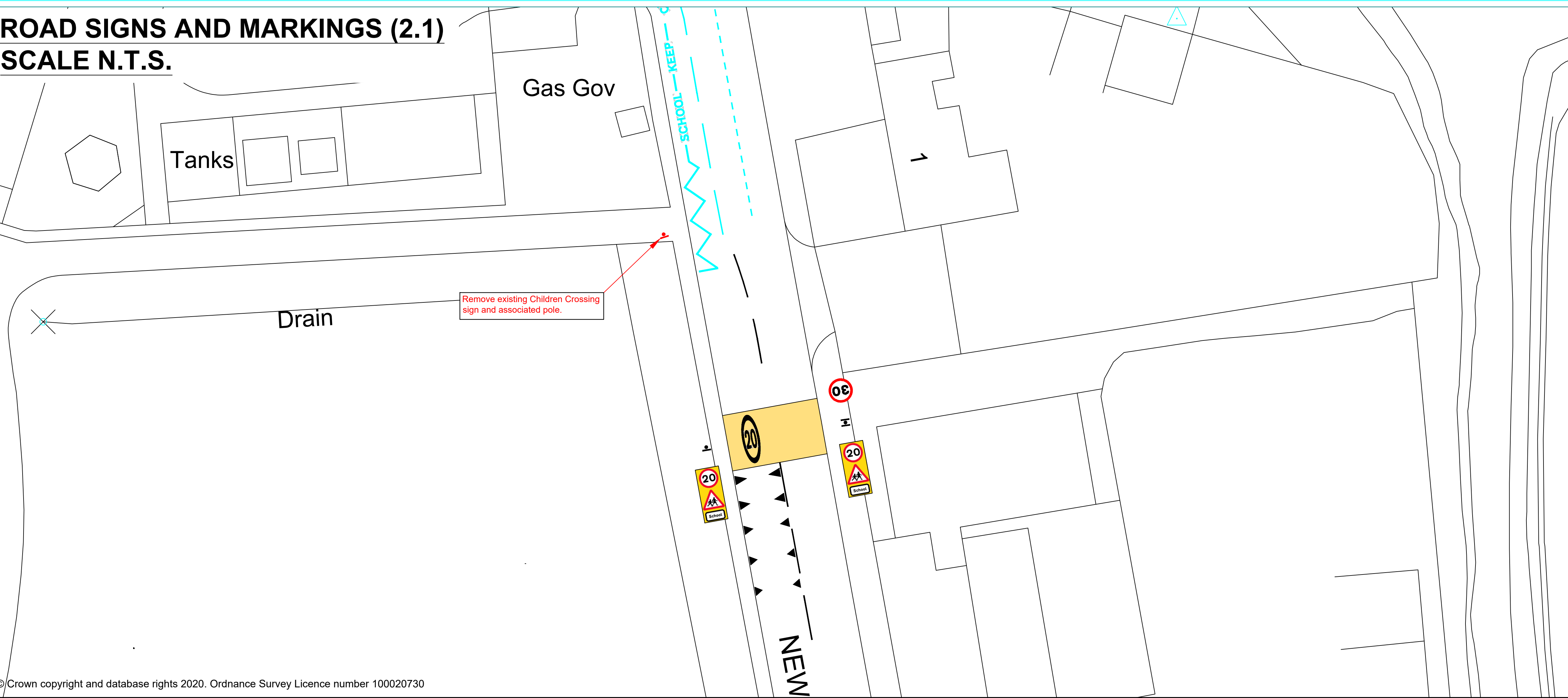

**Notes**

- Refer to Standard Drawings for dimensions.
- Contact Chris Murphy of SLC Traffic & Transportation on 07385 370094 if in doubt.
- All road signs and markings to conform to TSRGD 2016.

Rev:	Date:	Revisions	Checked Date:	Appvd Date:
South Lanarkshire Council, Community and Enterprise Resources				
Scale : N.T.S.		Date : 28/10/20		
Drawn by : CJM		Checked by : CS		
Drawing Status : TENDER		Approved by : CS		
Head of Roads and Transportation: Gordon Mackay B.Sc., C.Eng., M.I.C.E.				
Montrose House, 154 Montrose Crescent, Hamilton ML3 6LB				
Spaces for People Hallside and Park View Primary School's 20mph Speed Limit Road Signage and Markings Detail				
Drawing No:		TT/SFP/SCH/CR/HSPVPS/02		
Rev:				
File No:		Original Drawing Size: 594*841 (A1)		



ROAD SIGNS AND MARKINGS (3)  
SCALE N.T.S.

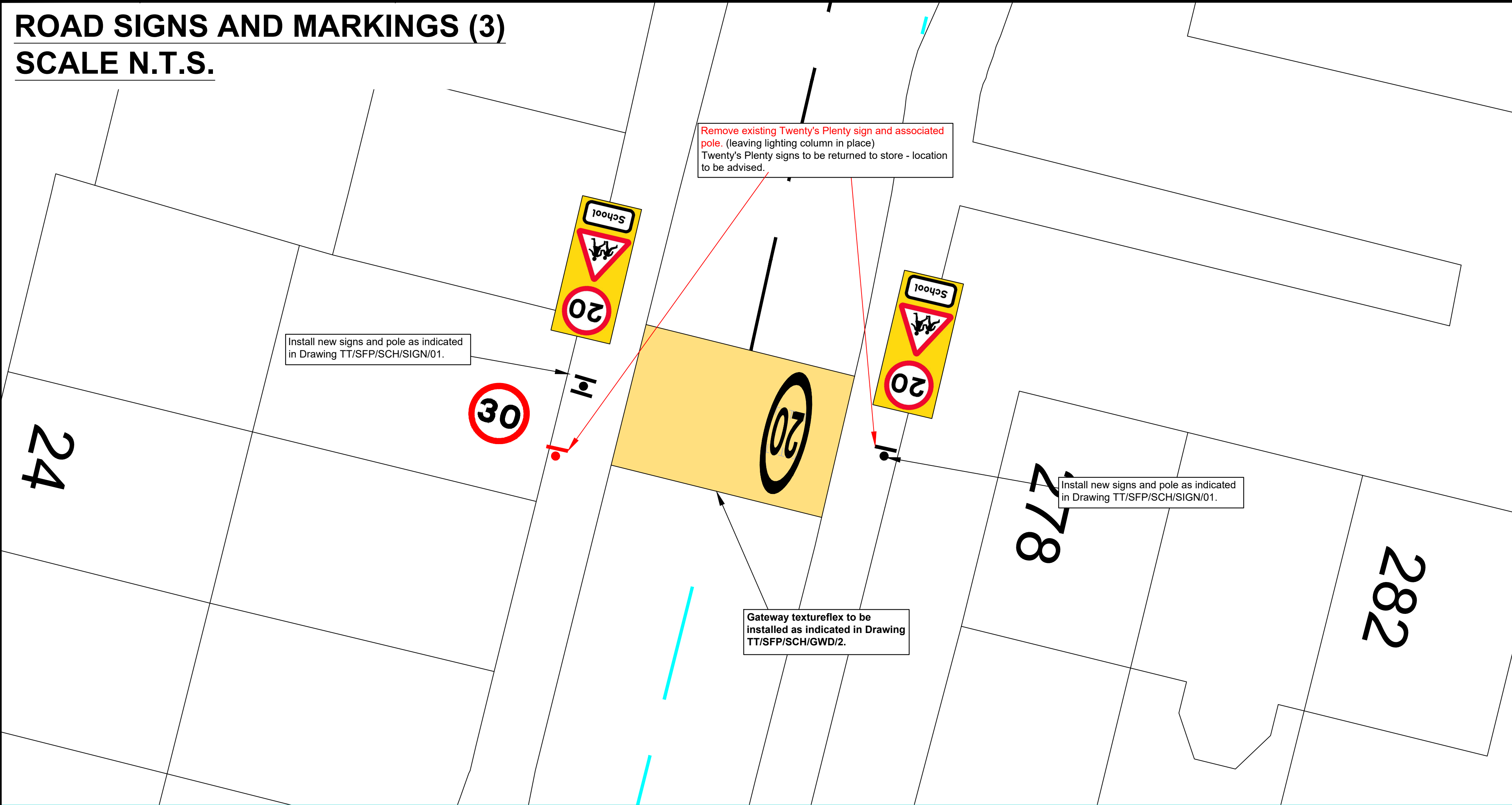

LOCATION PLAN  
SCALE N.T.S.

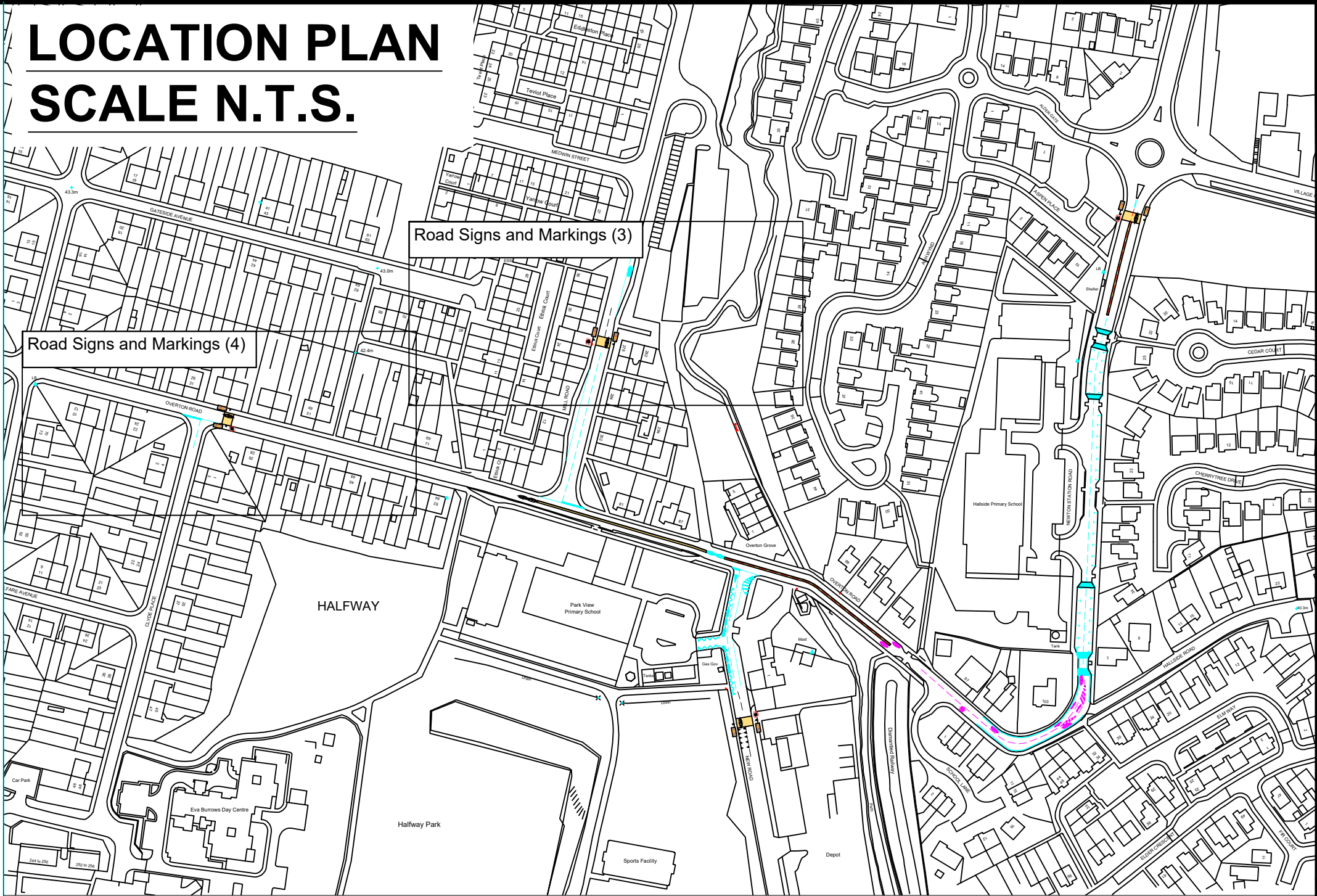

KEY

- New road markings to be laid in white thermoplastic
- New yellow textureflex surfacing to be laid
- Existing road markings to be removed
- Existing road markings to be refreshed
- Existing road markings to be retained
- New sign to be erected on new pole (existing signs and poles to be removed as indicated)
- New signs to be erected back-to-back on new pole (existing signs and poles to be removed as indicated)
- Existing sign and pole to be removed

ROAD SIGNS AND MARKINGS (4)  
SCALE N.T.S.

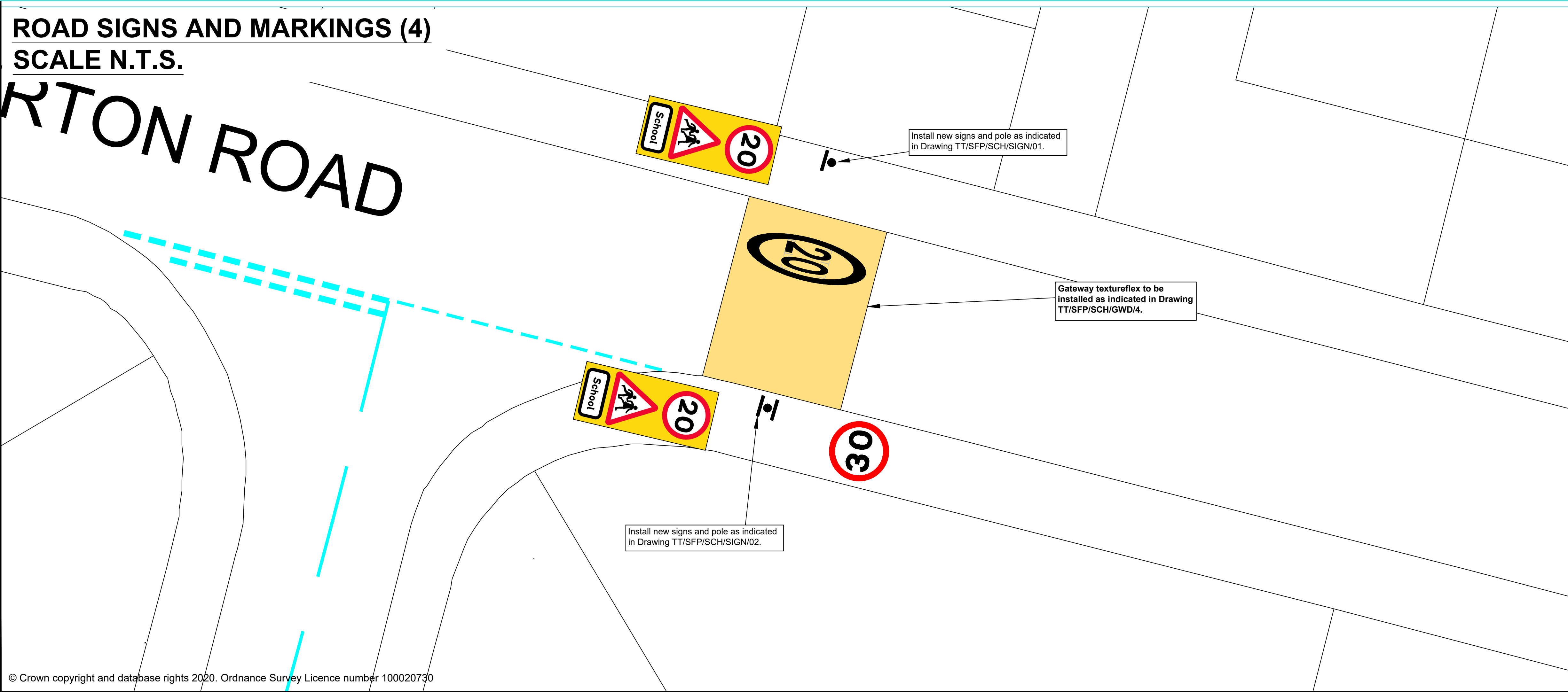

- Notes
- Refer to Standard Drawings for dimensions.
  - Contact Chris Murphy of SLC Traffic & Transportation on 07385 370094 if in doubt.
  - All road signs and markings to conform to TSRGD 2016.

Rev:	Date:	Revisions	Checked Date:	Appvd Date:
South Lanarkshire Council, Community and Enterprise Resources				
Scale	: N.T.S.	Date	: 28/10/20	
Drawn by	: CJM	Checked by	: CS	
Drawing Status	: TENDER	Approved by	: CS	
Head of Roads and Transportation: Gordon Mackay B.Sc., C.Eng., M.I.C.E.				
Montrose House, 154 Montrose Crescent, Hamilton ML3 6LB				
Spaces for People Hallside and Park View Primary School's 20mph Speed Limit Road Signage and Markings Detail				
Drawing No:		TT/SFP/SCH/CR/HSPVPS/03		
Rev:				
File No:				Original Drawing Size: 594*841 (A1)



ROAD SIGNS AND MARKINGS (5)  
SCALE N.T.S.

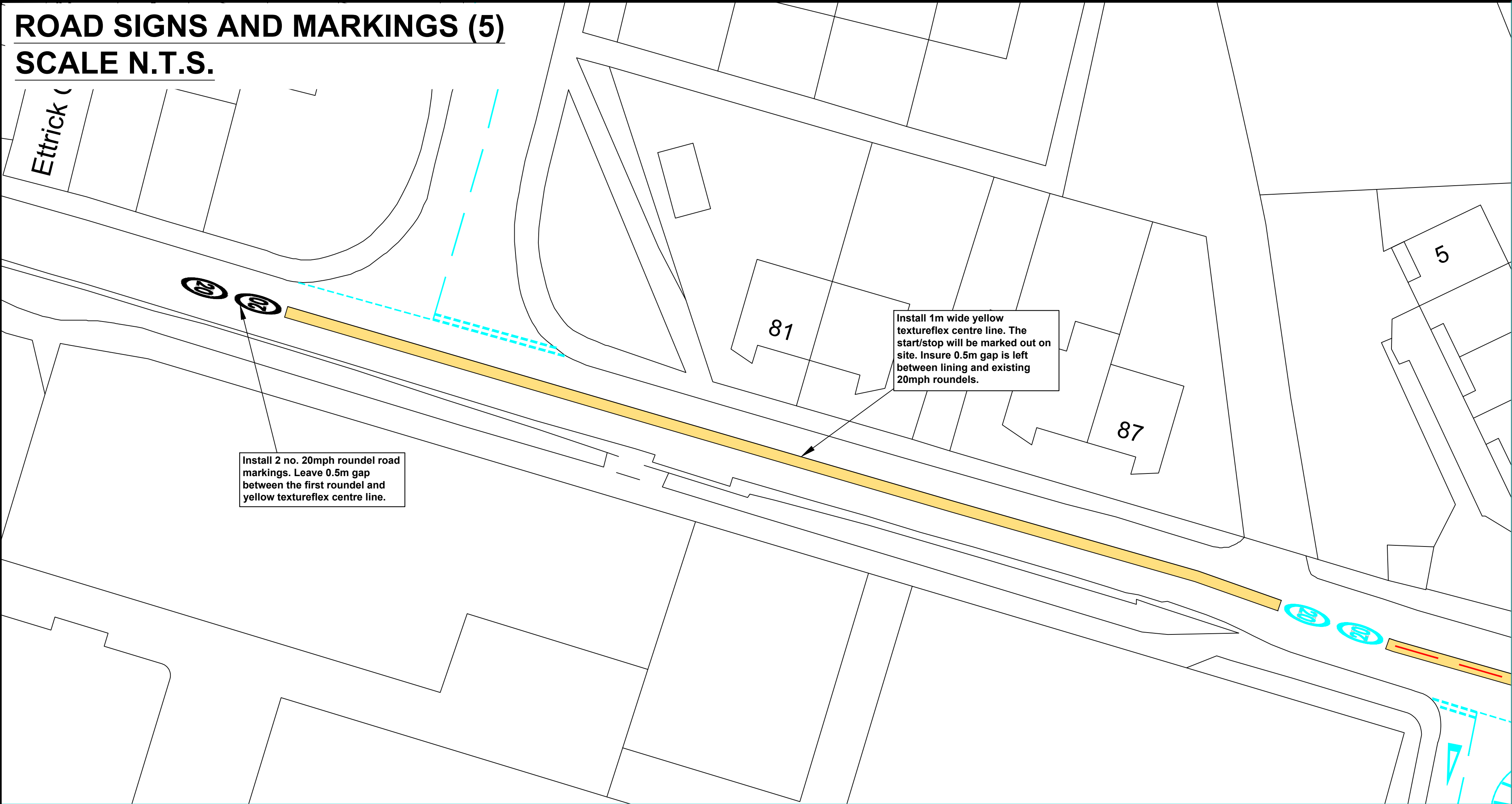

LOCATION PLAN  
SCALE N.T.S.

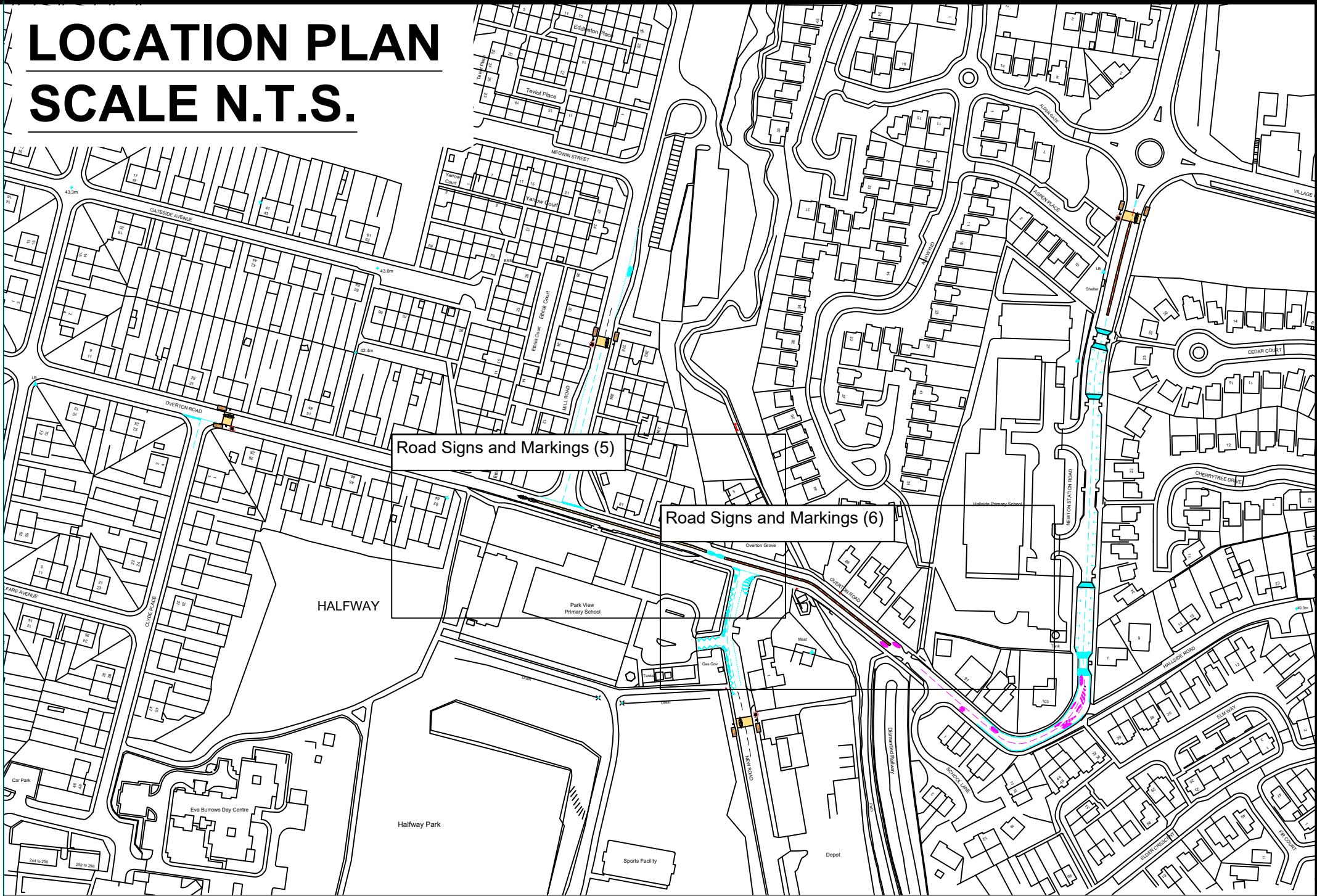

KEY

- New road markings to be laid in white thermoplastic
- New yellow textureflex surfacing to be laid
- Existing road markings to be removed
- Existing road markings to be refreshed
- Existing road markings to be retained
- New sign to be erected on new pole (existing signs and poles to be removed as indicated)
- New signs to be erected back-to-back on new pole (existing signs and poles to be removed as indicated)
- Existing sign and pole to be removed

ROAD SIGNS AND MARKINGS (6)  
SCALE N.T.S.

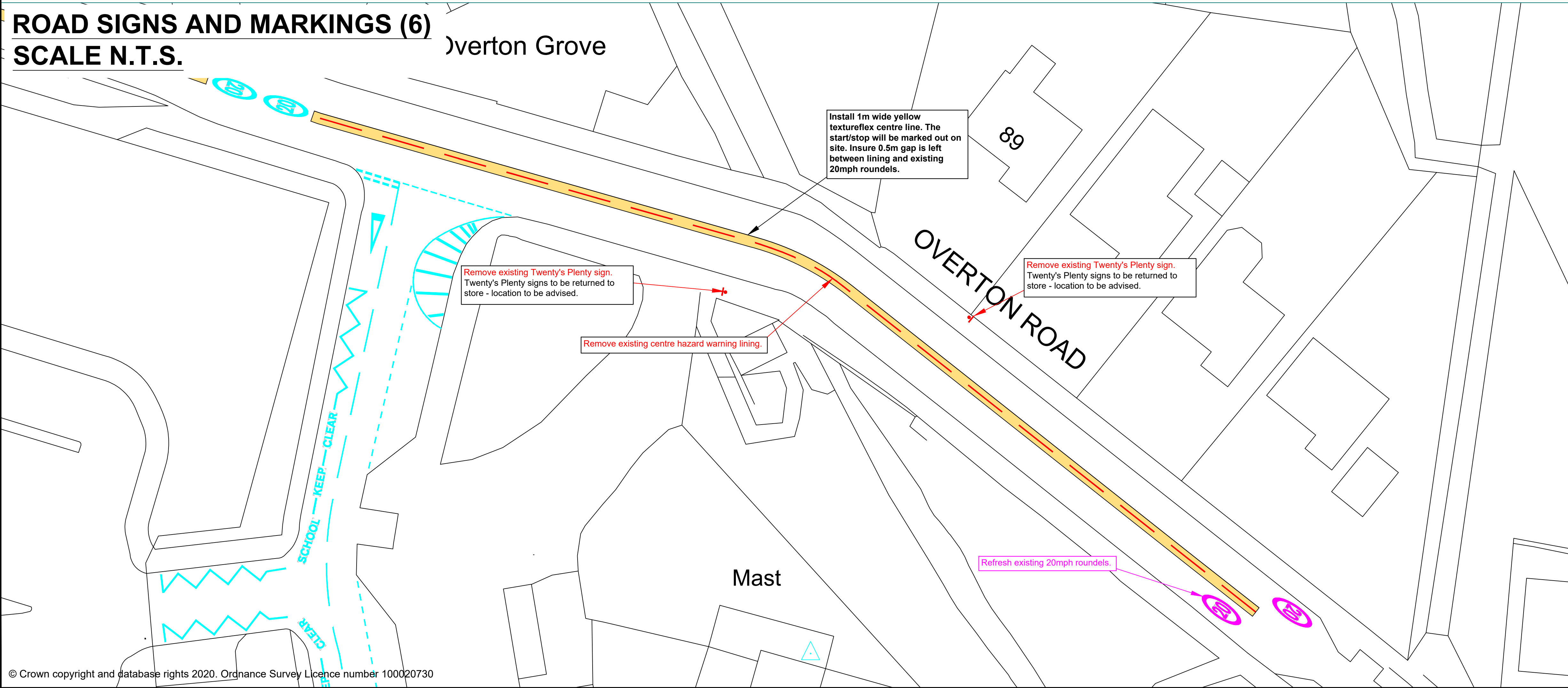

- Notes
- Refer to Standard Drawings for dimensions.
  - Contact Chris Murphy of SLC Traffic & Transportation on 07385 370094 if in doubt.
  - All road signs and markings to conform to TSRGD 2016.

Rev:	Date:	Revisions	Checked Date:	Appvd Date:
South Lanarkshire Council, Community and Enterprise Resources				
Scale	: N.T.S.	Date	: 28/10/20	
Drawn by	: CJM	Checked by	: CS	
Drawing Status	: TENDER	Approved by	: CS	
Head of Roads and Transportation: Gordon Mackay B.Sc., C.Eng., M.I.C.E.				
Montrose House, 154 Montrose Crescent, Hamilton ML3 6LB				
Spaces for People Hallside and Park View Primary School's 20mph Speed Limit Road Signage and Markings Detail				
Drawing No:		TT/SFP/SCH/CR/HSPVPS/04		
Rev:				
File No:				Original Drawing Size: 594*841 (A1)



ROAD SIGNS AND MARKINGS (7)  
SCALE N.T.S.

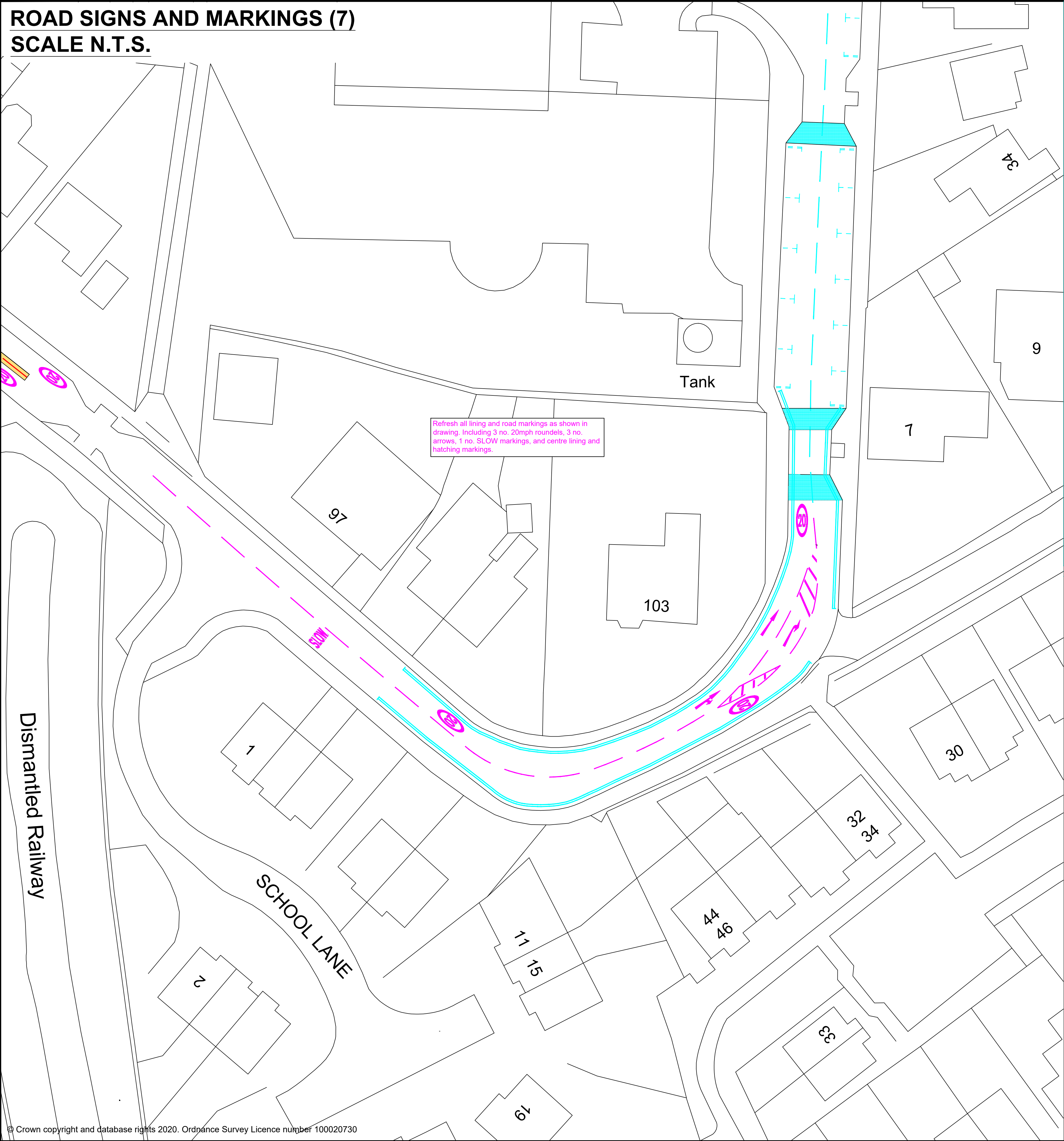

LOCATION PLAN  
SCALE N.T.S.

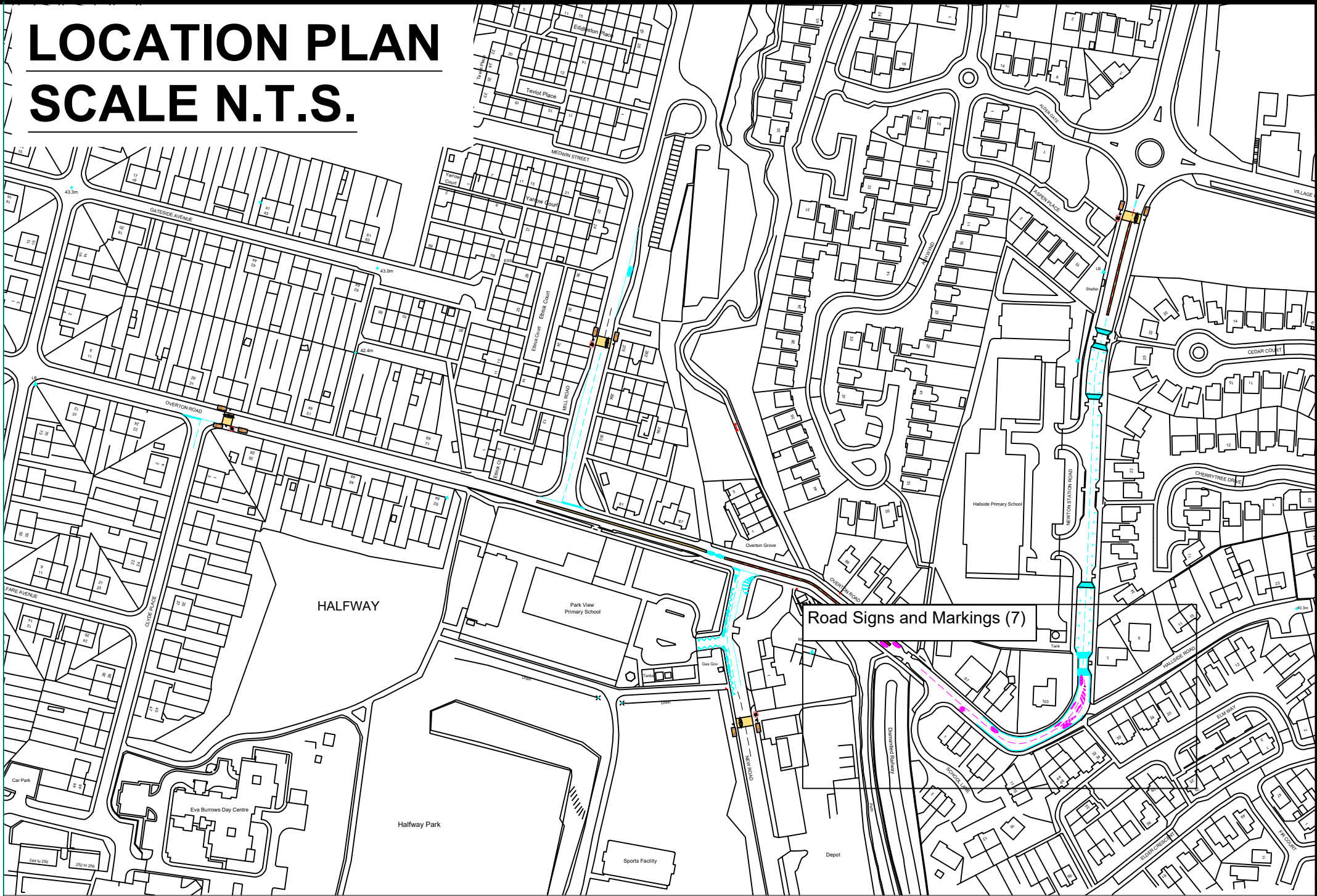

KEY

- New road markings to be laid in white thermoplastic
- New yellow textureflex surfacing to be laid
- Existing road markings to be removed
- Existing road markings to be refreshed
- Existing road markings to be retained
- New sign to be erected on new pole  
(existing signs and poles to be removed as indicated)
- New signs to be erected back-to-back on new pole  
(existing signs and poles to be removed as indicated)
- Existing sign and pole to be removed

- Notes
- Refer to Standard Drawings for dimensions.
  - Contact Chris Murphy of SLC Traffic & Transportation on 07385 370094 if in doubt.
  - All road signs and markings to conform to TSRGD 2016.

Rev:	Date:	Revisions	Checked Date:	Appvd Date:
South Lanarkshire Council, Community and Enterprise Resources				
Scale	: N.T.S.	Date	: 28/10/20	
Drawn by	: CJM	Checked by	: CS	
Drawing Status	: TENDER	Approved by	: CS	
Head of Roads and Transportation: Gordon Mackay B.Sc., C.Eng., M.I.C.E.				
Montrose House, 154 Montrose Crescent, Hamilton ML3 6LB				
Spaces for People Hallside and Park View Primary School's 20mph Speed Limit Road Signage and Markings Detail				
Drawing No:		TT/SFP/SCH/CR/HSPVPS/05		
Rev:				
File No:				Original Drawing Size: 594*841 (A1)